

**QUESTION:**

**Given:**

- \* The floor plan of an office with a toilet.
- \* Plaster walls **without** hatching.
- \* Given information sheet of all sanitary fixtures. (**Drawing sheet 99**)
- \* Position of the door frames as a **starting point** of the drawing on the answer sheet.

**Instructions:**

- \* Using a scale of 1:25, copy the given floor plan.
- \* The conventional representation of the door, windows and sanitary fixtures must be used.
- \* Label the floor plan, scale, room designation and tile floor finishing.
- \* Show **plaster** wall hatching according to the SANS 10143.
- \* A schedule of areas detailing the floor area (m<sup>2</sup>) and the perimeter (m) of the office **with** the toilet.
- \* Special attention must be paid to accuracy, standards and graphic symbols.

**Note:**

- \* Load-bearing walls are 222 mm.
- \* Non loadbearing wall is 111 mm.

NOTE:  
USE THE GIVEN CIVIL  
INFORMATION SHEET ON  
DRAWING SHEET 99



LET WEL:  
GEBRUIK DIE GEGEWE  
SIVIELE INLIGTINGSBLAD  
OP TEKENVEL 99

**VRAG:**

**Gegee:**

- \* Die vloerplan van 'n kantoor met 'n toilet.
- \* **Pleistermure sonder** ansering.
- \* Gegee inligtingsblad van al die sanitêre toebehore. (**Tekenvel 99**)
- \* Posisie van die **deurraam** as die **beginpunt** van die lekening op die antwoordblad.

**Instrukties:**

- \* Kopieer die vloerplan deur gebruik te maak van 'n skaal 1:25.
- \* Die konvensionele voorstellings van die deure, vensters en sanitêre toebehore moet gebruik word.
- \* Benoem die vloerplan, skaal, kameraanwysings en teëlvloerwerkings.
- \* Toon **pleister** muuranwysing volgens SANS 10143.
- \* 'n Skedule wat die totale vloeroppervlakte (m<sup>2</sup>) en die omtrek (m) van die kantoor **met** die toilet toon.
- \* Spesiale aandag moet gegee word aan akkuraatheid, standaarde en grafiese simbole.

**Let wel:**

- \* Lasdraende mure is 222 mm.
- \* Nie-lasdraende muur is 111 mm.

**SCHEDULE OF AREAS:**

| FLOOR AREA                |
|---------------------------|
| = L x B                   |
| = 3,85 x 3,25             |
| = 12,51 m <sup>2</sup>    |
| PERIMETER                 |
| = (2 x L) + (2 x B)       |
| = (2 x 3,85) + (2 x 3,25) |
| = 7,7 + 6,5 = 14,2m       |

**SKEDULE VAN OPPERVLAKTES:**

| VLOEROPPERVLAKTE          |
|---------------------------|
| = L x B                   |
| = 3,85 x 3,25             |
| = 12,51 m <sup>2</sup>    |
| OMTREK                    |
| = (2 x L) + (2 x B)       |
| = (2 x 3,85) + (2 x 3,25) |
| = 7,7 + 6,5 = 14,2m       |

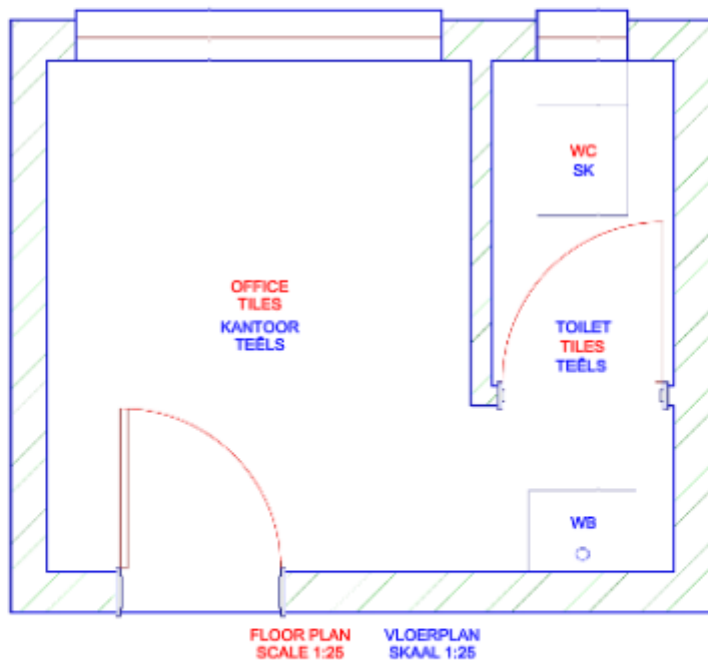

| RUBRIC CORRECTNESS / RUBRIEK KORREKTHEID |                         |
|--|-------------------------|
| OUTSTANDING / UITSTEKEND                 | 100% 7                  |
| VERY GOOD / BAIE GOED                    | ± 85% 6                 |
| GOOD / GOED                              | ± 70% 5                 |
| SATISFACTORY / BEVREDIGEND               | ± 55% 4                 |
| ACCEPTABLE / AANVAARBAAR                 | ± 40% 3                 |
| UNACCEPTABLE / ONAANVAARBAAR             | ± 33% 2                 |
| VERY BAD / BAIE SWAK                     | ± 25% & LESS / MINDER 1 |
| NON COMPLIANCE / NIE VOLDOEN             | NC                      |
| QUALITY & NEATNESS / KWALITEIT & NETHEID |                         |
| OUTSTANDING / UITSTEKEND                 | 80% + 3                 |
| SATISFACTORY / BEVREDIGEND               | 60% + 2                 |
| VERY BAD / BAIE SWAK                     | 50% & LESS / MINDER 1   |
| NON COMPLIANCE / NIE VOLDOEN             | NC                      |
| <b>TOTAL / TOTAAL</b>                    | <b>10</b>               |



NAME / NAAM: \_\_\_\_\_  
GRADE / GRAAD 10: \_\_\_\_\_

**ENGINEERING GRAPHICS & DESIGN**  
**INGENIEURSGRAFIKA & ONTWERP**

CIVIL DRAWING / SIVIELE TEKENING \_\_\_\_\_  
DATE / DATUM: \_\_\_\_\_

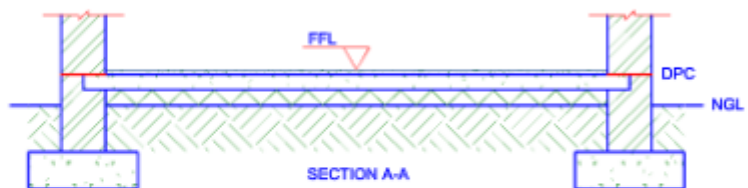

| SCHEDULE OF AREA  |                                   |
|-------------------|-----------------------------------|
| <b>FLOOR AREA</b> |                                   |
| =                 | $L \times B$                      |
| =                 | $3,232 \times 3$                  |
| =                 | $9,696 \text{ m}^2$               |
| <b>PERIMETER</b>  |                                   |
| =                 | $(2 \times L) + (2 \times B)$     |
| =                 | $(2 \times 3,232) + (2 \times 3)$ |
| =                 | $6,464 + 6 = 12,464 \text{ m}$    |

Use marking rubric p 46 of the CAPS for multi-view civil working drawings.

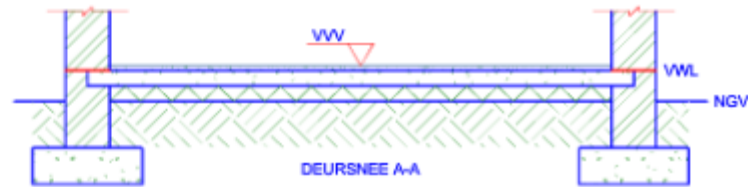

| SKEDULE VAN OPPERVLAKTES: |                       |
|---------------------------|-----------------------|
| VLOEROPPERVLAKTE          |                       |
| ■                         | L x B                 |
| ■                         | 3,232 x 3             |
| ■                         | 9,696 m <sup>2</sup>  |
| OMTREK                    |                       |
| ■                         | (2 x L) + (2 x B)     |
| ■                         | (2 x 3,232) + (2 x 3) |
| ■                         | 8,464 + 6 = 12,464 m  |

Gebruik merkhout of 44 van die K48V vir multi-aansig  
 sivele vertekeninge.

| SCHEDULE OF AREAS |                                     |
|-------------------|-------------------------------------|
| <b>FLOOR AREA</b> |                                     |
| •                 | $L \times B$                        |
| •                 | $6,55 \times 5,15$                  |
| •                 | $33,732 \text{ m}^2$                |
| <b>PERIMETER</b>  |                                     |
| •                 | $(2 \times L) + (2 \times B)$       |
| •                 | $(2 \times 6,55) + (2 \times 5,15)$ |
| •                 | $13,1 + 10,3 = 23,4 \text{ m}$      |

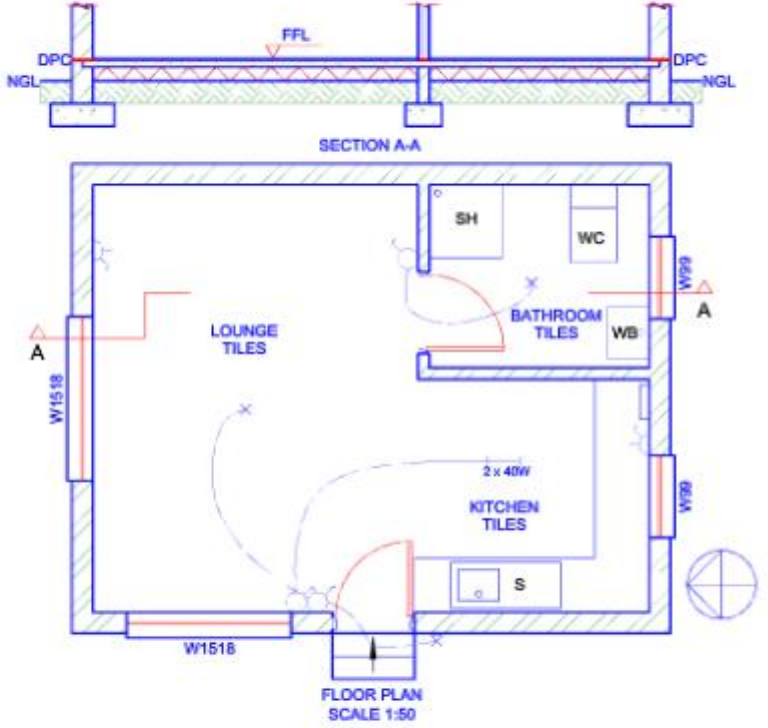

Use marking rubric p 46 of the CAPS for multi-view civil working drawings.



NAME: \_\_\_\_\_  
 GRADE 10: \_\_\_\_\_

**ENGINEERING GRAPHICS & DESIGN**

CIVIL DRAWING  
 DATE: \_\_\_\_\_

| VLOEROPPERVLAKTE          |  |
|---------------------------|--|
| ■ L x B                   |  |
| ■ 6,55 x 5,15             |  |
| ■ 33,732 m <sup>2</sup>   |  |
| OMTREK                    |  |
| ■ (2 x L) + (2 x B)       |  |
| ■ (2 x 6,55) + (2 x 5,15) |  |
| ■ 13,1 + 10,3 = 23,4 m    |  |

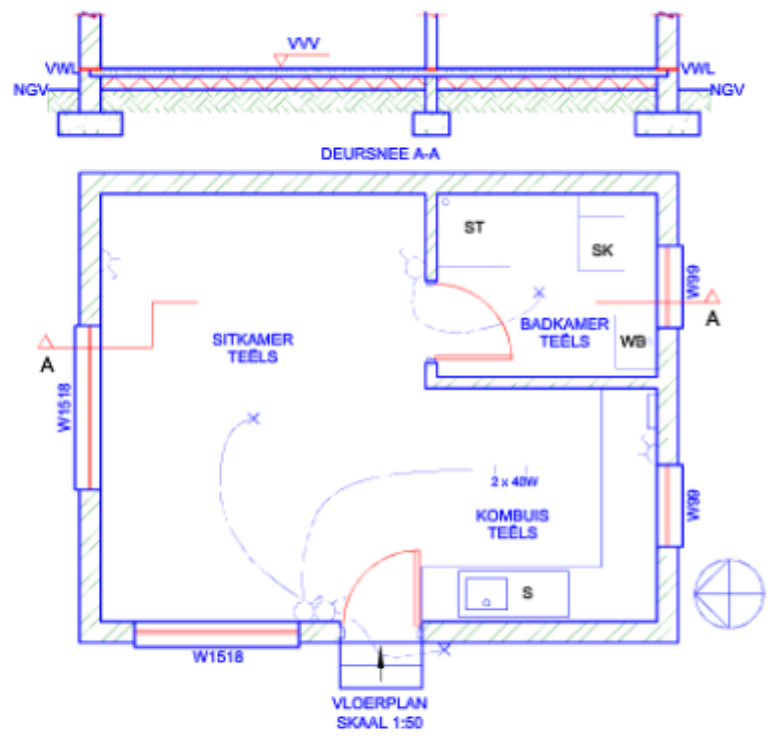

Gebruik merkbriek bl 44 van die KABV vir multi-aansig siviele werktekeninge.

JP  
 NAAM: \_\_\_\_\_  
 GRAAD 10: \_\_\_\_\_

INGENIEURSGRAFIKA & ONTWERP

SMELE TEKENING  
 DATUM: \_\_\_\_\_